

# A280

series

Piston Accumulators 活塞式蓄壓器

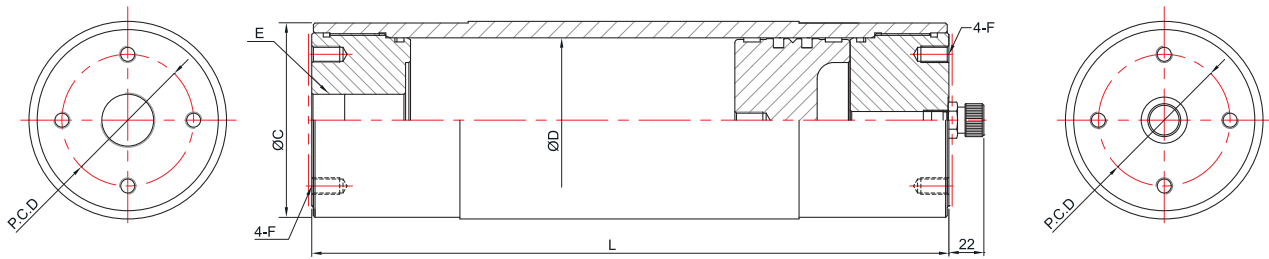

## MODEL CODE

### SERIES

**A**=Piston Accumulators

### MAX WORKING PRESSURE(bar)

**280**=280bar

### MATERIAL OF SEALS

**S**=NBR/PTFE compound

**V**=FKM/PTFE compound

### PISTON DIAMETER

**08**=80mm

**10**=100mm

**16**=160mm

**18**=180mm

**25**=250mm

### CERTIFICATE CODE

**U**=PED 2014/68/EU

### NOMINAL VOLUME(LITRE)

**20**=20L

### FLUID CONNECTION

**S**=Standard

### GAS SIDE CONNECTION

**S**=Standard

### PRE-CHARGE PRESSURE (bar)

**000**=0bar

**030**=30bar

**A 280 - S - 16 - U - 20 - S S - 000**

SPECIAL SIZES AND SPECIAL VERSIONS ON REQUEST.

## DIMENSION

LITRE	L	ØC	ØD	E	F	P.C.D
0.5	270	95	80	G 3/4	M10X1.5	60
1	370	95	80	G 3/4	M10X1.5	60
2	570	95	80	G 3/4	M10X1.5	60
3	770	95	80	G 3/4	M10X1.5	60
4	970	95	80	G 3/4	M10X1.5	60
5	1170	95	80	G 3/4	M10X1.5	60
2	450	120	100	G 1	M10X1.5	80
3	580	120	100	G 1	M10X1.5	80
4	710	120	100	G 1	M10X1.5	80
5	840	120	100	G 1	M10X1.5	80
8	1230	120	100	G 1	M10X1.5	80
10	1490	120	100	G 1	M10X1.5	80
10	755	190	160	G 1,1/4	M16X2.0	135
15	1005	190	160	G 1,1/4	M16X2.0	135
20	1255	190	160	G 1,1/4	M16X2.0	135
25	1505	190	160	G 1,1/4	M16X2.0	135
30	1755	190	160	G 1,1/4	M16X2.0	135
40	2255	190	160	G 1,1/4	M16X2.0	135
10	670	216	180	G 1,1/4	M16X2.0	150
15	870	216	180	G 1,1/4	M16X2.0	150
20	1070	216	180	G 1,1/4	M16X2.0	150
25	1270	216	180	G 1,1/4	M16X2.0	150
30	1470	216	180	G 1,1/4	M16X2.0	150
40	1870	216	180	G 1,1/4	M16X2.0	150
30	965	299	250	G 1,1/2	M16X2.0	210
40	1170	299	250	G 1,1/2	M16X2.0	210
50	1375	299	250	G 1,1/2	M16X2.0	210
60	1580	299	250	G 1,1/2	M16X2.0	210
80	1990	299	250	G 1,1/2	M16X2.0	210
100	2400	299	250	G 1,1/2	M16X2.0	210

## TECHNICAL DATA

Operating pressure : Max.280bar

Operating temperature : NBR -30°C to +80°C

Mounting type : any position

## STANDARD CONSTRUCTION CHARACTERISTICS

Gas connection valve : 5/8"-18UNF

Painting : anti-rust primer

Test : standard factory tested

Piston speed : standard 1m/s

**ASHUN** piston accumulators consist of :

- A cylinder with very finely machined internal surface.
- End caps on the gas side and the oil side. Sealed with O-rings.
- A floating steel or aluminium piston.
- A sealing system adapted to the particular application. The piston floats on two guide rings which prevent metal-to-metal contact between the piston and the accumulator wall. Suitable materials are also available for low temperature applications.